

# HIKOKI

## CIRCULAR SAW C6MEY

Item No.	Code No.	Description	No. Used	Remarks
1	329975	WASHER (A)	1	
2A	370007	BEARING HOLDER ASS'Y	1	INCLUD. 6A-8,14-17
3	940079	RETAINING RING FOR D8 SHAFT	1	
4	339378	COUPLING COVER	1	
5	339377	COUPLING DAMPER	4	
6A	370008	SECOND SHAFT ASS'Y (A)	1	
7	606ZZM	BALL BEARING 606VV	1	
8	338921	BEARING HOLDER	1	
9	951039	MACHINE SCREW (W/SP. WASHER) M4X12	3	
10	339257	WASHER	1	
11	338926	RETURN SPRING	1	
12	939548	RETAINING RING FOR D22 SHAFT (10 PCS.)	1	
13A	376366	WASHER (A)	1	
14	338923	SPINDLE GEAR SET	1	
15	949203	MACHINE SCREW M3X8 (10 PCS.)	2	
16	338922	BEARING COVER	1	
17	6901VV	BALL BEARING 6901VV	1	
18A	338905	LOWER GUARD	1	
19	338927	KNOB	1	
20	302090	TAPPING SCREW D4X10 (BLACK)	1	
21	338935	TCT SAW BLADE 165MM-D20 HOLE-NT24	1	
22A	376367	WASHER (B)	1	
23	338917	HEX. FLANGE BOLT	1	
24A	373653	SAW COVER	1	
25	333781	MACHINE SCREW (W/WASHER) M4X12 (BLACK)	1	
26	323211	MACHINE SCREW M4X8 (BLACK)	2	
27	339220	LED	1	
*28	361011	ROTOR ASS'Y	1	INCLUD. 106,107 TILL 5.2018 FOR AUS,NZL
*28A	361078	ROTOR (C) ASS'Y	1	INCLUD. 106,107 SINCE 6.2018 FOR AUS,NZL, MODEL (S)
29	339374	LED-CASE (C)	1	
30	338918	LOCK LEVER	1	
31A	371943	LINK	1	SINCE 8.2017
32	339258	GAUGE PLATE (A)	1	
33	334225	SPRING	1	
34	307811	TAPPING SCREW (W/FLANGE) D4X16 (BLACK)	6	
35	319541	SEAL LOCK HEX. SOCKET SET SCREW M5X6	3	
35	319541	SEAL LOCK HEX. SOCKET SET SCREW M5X6	1	TILL 10.2019
36	338907	GEAR COVER	1	TILL 10.2019
36B	376033	GEAR COVER	1	SINCE 11.2019
37	310842	CUSHION	1	
38	949793	FLAT HD. SCREW M5X20 (10 PCS.)	1	
39	334242	WAVE WASHER 8	1	TILL 10.2019
40A	371946	COVER PLATE	1	TILL 10.2019
41A	377291	NYLON NUT M5	2	
41A	377291	NYLON NUT M5	1	TILL 10.2019
42	338930	LEVER (A)	1	TILL 10.2019
43A	372219	SEAL LOCK SCREW (W/SP. WASHER) M4	1	TILL 10.2019
44	333681	CAM	1	TILL 10.2019
45A	371947	PLATE	1	TILL 10.2019
46	338932	LOCK SLEEVE	1	TILL 10.2019
47	333680	CAM SHAFT	1	TILL 10.2019
47A	375031	BOLT (SQUARE) M6X20	1	SINCE 11.2019

\* ALTERNATIVE PARTS

# HIKOKI

## CIRCULAR SAW C6MEY

Item No.	Code No.	Description	No. Used	Remarks
48	336650	SPRING	1	
49A	374780	KNOB	1	
50	338899	TRIGGER	1	
51	307887	MACHINE SCREW (W/WASHER) M3.5X6	2	
52A	371322	SWITCH	1	
53	305691	MACHINE SCREW (W/WASHERS) M4X14 (BLACK)	1	
*54	340913B	STATOR SENSOR PCB ASS'Y	1	TILL 5.2018 FOR AUS,NZL
*54A	341042	STATOR SENSOR PCB ASS'Y	1	SINCE 6.2018 FOR AUS,NZL,MODEL (S)
55	959141	CONNECTOR 50092 (10 PCS.)	2	
56	937631	CORD CLIP	1	
57	984750	TAPPING SCREW (W/FLANGE) D4X16	2	
58	953327	CORD ARMOR D8.8	1	
59A	371937	HANDLE SET (GREEN)	1	
60	334141	MACHINE SCREW (W/WASHERS) M4X35 (BLACK)	6	
61	338919	FLOW GUIDE	1	
62	338902	HOUSING SET	1	
63	336554	CUSHION	2	
64	338928	RUBBER BUSHING	1	
65	315500	MACHINE SCREW (W/WASHER) M4X8 (BLACK)	1	
66	338913	GUIDE PIECE	1	
67	942827	RETAINING RING (E-TYPE) FOR D8 SHAFT	1	
68	333660	SPECIAL NUT M6	1	
69	333659	CLAMP LEVER	1	
70	949425	WASHER M6 (10 PCS.)	2	
71	317200	MACHINE SCREW (W/WASHERS) M4X8 (BLACK)	1	
72	333657	STOPPER LEVER	1	
73	339259	SPRING (B)	1	
74	307898	WING BOLT M6X18	2	
75	324876	SPRING	2	
76A	377288	HEX. SOCKET SET SCREW M5X10	1	
77A	371941	BASE	1	
78	301653	TAPPING SCREW (W/FLANGE) D4X20 (BLACK)	4	
79	301653	TAPPING SCREW (W/FLANGE) D4X20 (BLACK)	1	
80	338934	SUB HANDLE	1	INCLUD.79
81		NAME PLATE	1	
82	339260	ADJUSTING SCREW (A)	1	
83	305490	TAPPING SCREW (W/FLANGE) D4X30 (BLACK)	2	
84	320163	STEP PIN D6X13	2	
85	314623	BOLT (SQUARE) M6X22	1	
86	338910	BEVEL PLATE	1	
87A	371944	SUB LINK	1	SINCE 8.2017
88	333664	SPECIAL BOLT	1	TILL 7.2017
88A	371945	SPECIAL SCREW	1	SINCE 8.2017
89	948167	SUPER LOCK WASHER M6	1	
90A	314623	BOLT (SQUARE) M6X22	1	
91	338938	CORD HOLDER	1	
*92	500247Z	CORD	1	(CORD ARMOR D8.8)
93B	371939	BASE ASS'Y	1	INCLUD.31A,32,35,41A,65-77A,84-90A,104, 108
*94	375110	WASHER	1	SINCE 6.2018 FOR AUS,NZL,MODEL (S)
98	942827	RETAINING RING (E-TYPE) FOR D8 SHAFT	1	SINCE 11.2019
99	374246	LEVER	1	SINCE 11.2019
100	374248	LOCK NUT	1	SINCE 11.2019

\* ALTERNATIVE PARTS



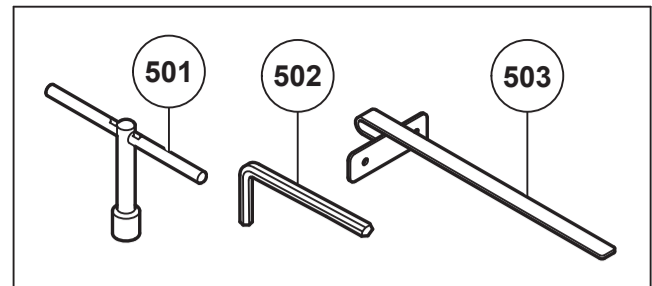

- 105A
- 36B 47A
- 98 ~ 104

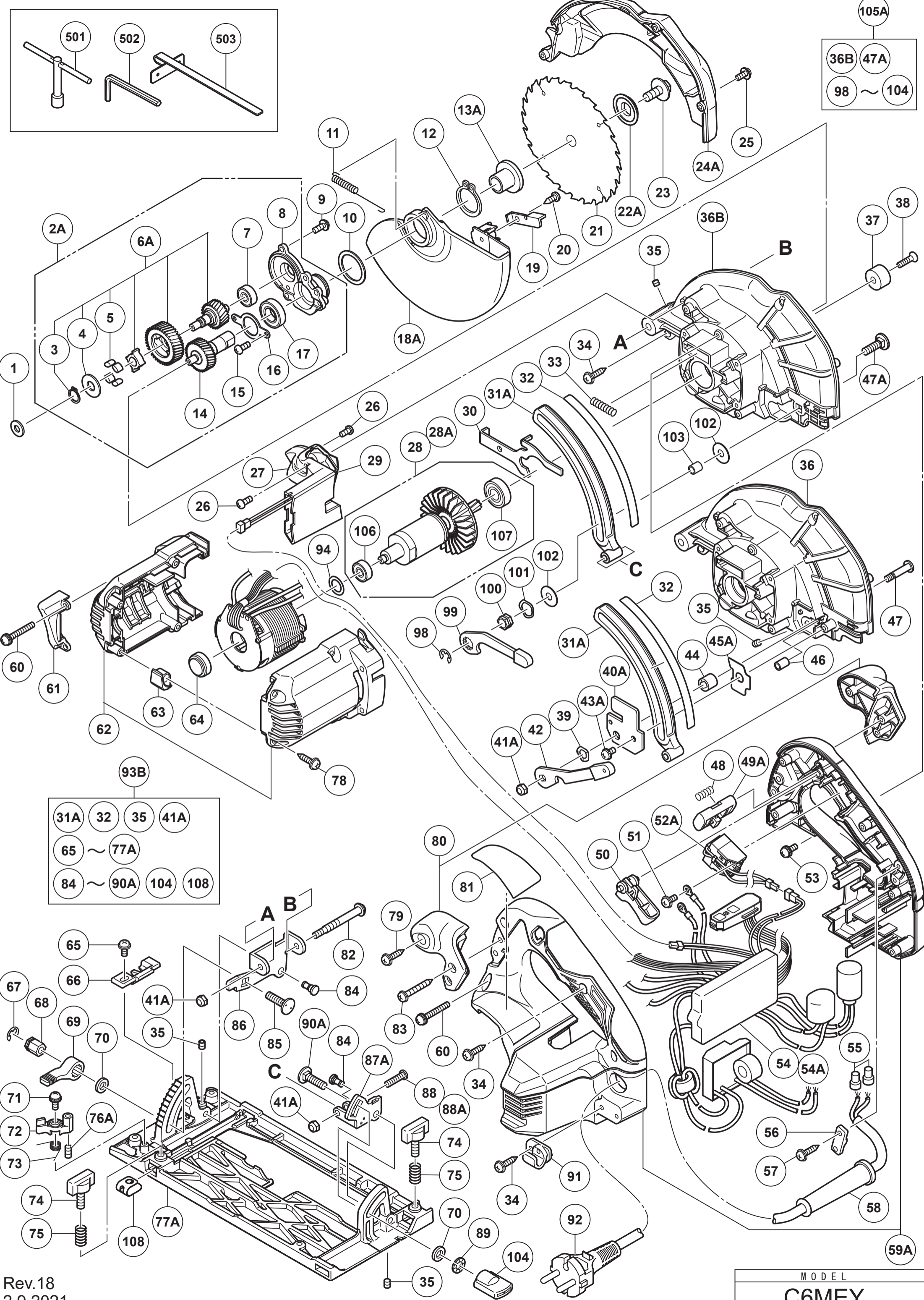

- 31A 32 35 41A
- 65 ~ 77A
- 84 ~ 90A 104 108

Rev.18  
2.9.2021

MODEL  
**C6MEY**